

UNIQUE Series High Frequency Online UPS

6- 10KVA (1 Ph in/1 Ph out)

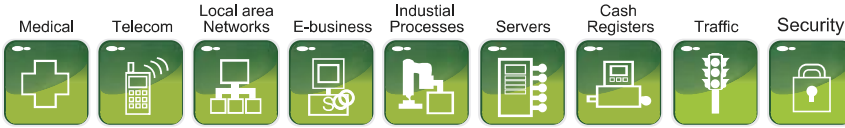

► Product snapshot:

Model: 6-10KVA

Nominal voltage: 208/220/230/240VAC

Nominal frequency: 50/60Hz

Output Power factor: 0.7/0.8 (Optional)

Key Features

- Large blue back light LCD for detailed real-time UPS status display.
- Advanced online pure sinewave power supply system, with bypass maintain switch, It can provide a reliable, high quality AC power source to the precision equipments, can be used widely in different fields.
- Widely used to computer equipments, telecommunication systems and industrial automatic control equipments.
- Truly online design, it can adjust the input voltage, filtering, when the AC break off, the UPS will provide an uninterruptible power source from the backup batteries.
- UPS will change to bypass mode when overloading or inverter fault, when over-loading remove, UPS will turn to inverter mode automatically.
- N+X Parallel Redundancy and Capacity expansion for 6K-20K (Up to three units) .



Stable and Reliable , Comprehensive Protection

UNIQUE 11 series of single phase in/single phase out with high frequency online double conversion UPS is a stability and reliability. Its excellent quality and perfect usability can provide the network power supply a safe and reliable protection, satisfy the users` requirements of protecting overall equipments.



DIŞ TİCARET LTD. ŞTİ.
www.powerguardups.com.tr

Trendy & Elegant LCD Design for real-time UPS system information

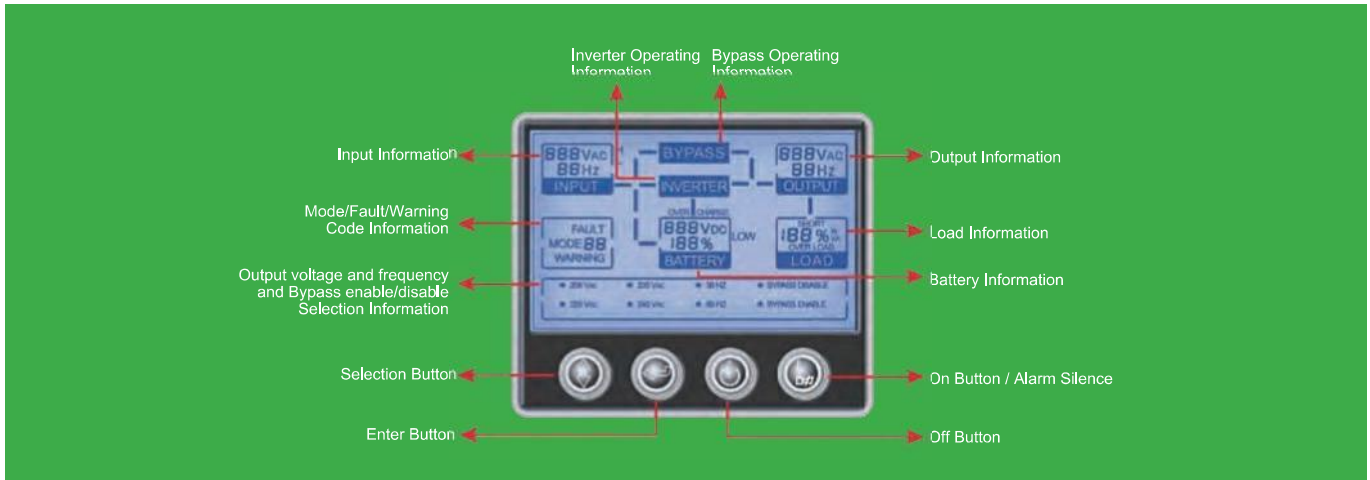

Back Panel Description:

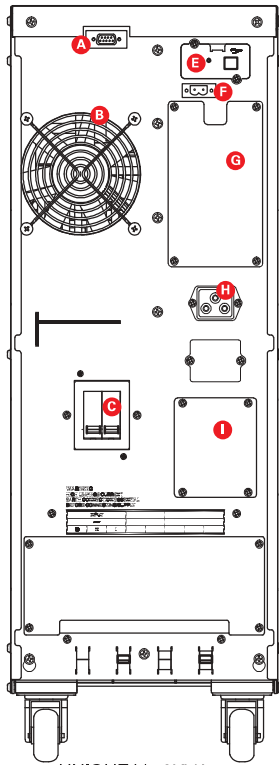

- A** Communication Port
- B** Cooling Fan
- C** Input Breaker
- D** Terminal Blocks Cover
- E** Intelligent Slot /USB Port (Optional)
- F** EPO
- G** Parallel Port
- H** External Battery (For Long Backup Time UPS Only)
- I** Maintenance Bypass Switch

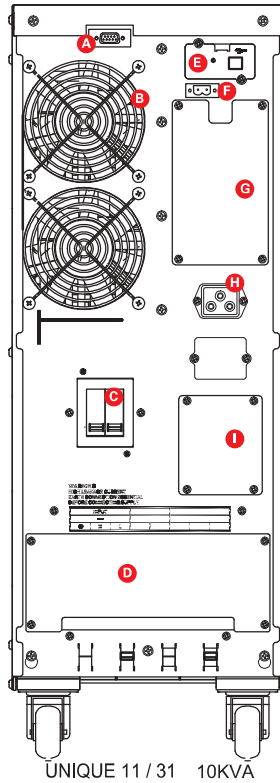

- A** Communication Port
- B** Cooling Fan
- C** Input Breaker
- D** Terminal Blocks Cover
- E** Intelligent Slot /USB Port (Optional)
- F** EPO
- G** Parallel Port
- H** External Battery Socket (For Long Backup Time UPS Only)
- I** Maintenance Bypass Switch

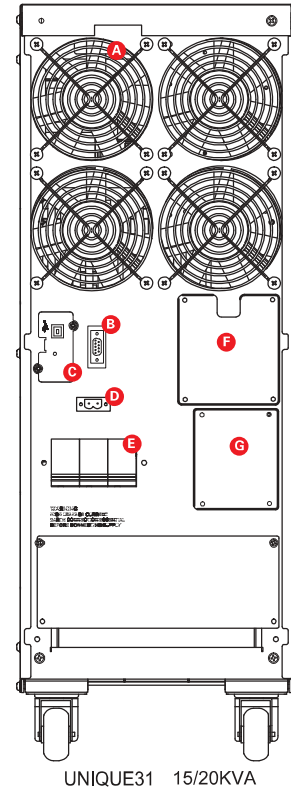

- A** Fan
- B** RS232
- C** Intelligent Slot /USB Port(Optional)
- D** EPO
- E** Input Breaker
- F** Parallel Port
- G** Maintenance Switch

HP9116C series Technical Specifications

Model	UNIQUE 11 6-10KVA				
	006-UQ		010-UQ		
Rated Power	6KVA/4.8KW		10KVA/8KW		
Rated Voltage	220/230/240VAC				
Rated Frequency	50/60 Hz				
Input					
Voltage Range	176~279VAC (±3VAC)				
Frequency Range	50HZ: (46~54HZ) ; 60HZ: (56HZ~64HZ)				
Power Factor	0.98				
Output					
Voltage Regulation	208/220/230/240X (1±2%)VAC				
Frequency Regulation	50/60 Hz±0.05Hz				
Power Factor	0.7/0.8 (Optional) Standard 0.7				
Voltage Distortion	Linear load<3% Non-linear load<6%				
Overload Capability	105%~130% for 10 min; ≥130% for 1min				
Current Crest Ratio	3 : 1				
Transfer Time	0ms (AC mode→Battery mode)				
Battery					
DC Voltage	240 VDC				
Recharge Time	7hrs to 90% of capacity after full load discharge				
Recharge Current	2A	4.2A	2A	4.2A	
Display					
LCD	Display input/output Voltage, Frequency, Battery voltag, Battery capacity, Loading rate.				
Communication					
Interface	Smart RS232、SNMP card (optional) 、USB (optional)				
Environment					
Operation Temperature	0~40 C				
Humidity	0~95% (Non-condensing)				
Storage Temperature	-25 C ~55 C				
Sea Level Elevation	<1500m				
Noise Level (1m)	<55dB				
Physics Characteristic					
Weight (KG)	N.W	79.0	33.5	81.5	36.0
	G.W	87.5	39.5	90.0	42.0
Dimensions : (Wx D x H)mm	260X570X717				

STANDARD: Conform to GB/IEC regulation: EMC:GB7260.2/IEC62040-2 GB/17626.2~5/IEC61000-4-2~5 SAFETY:GB4943

Note: Product specifications are subject to change without further notice.